

THEATRE IN THE STYLE OF CLASSICISM

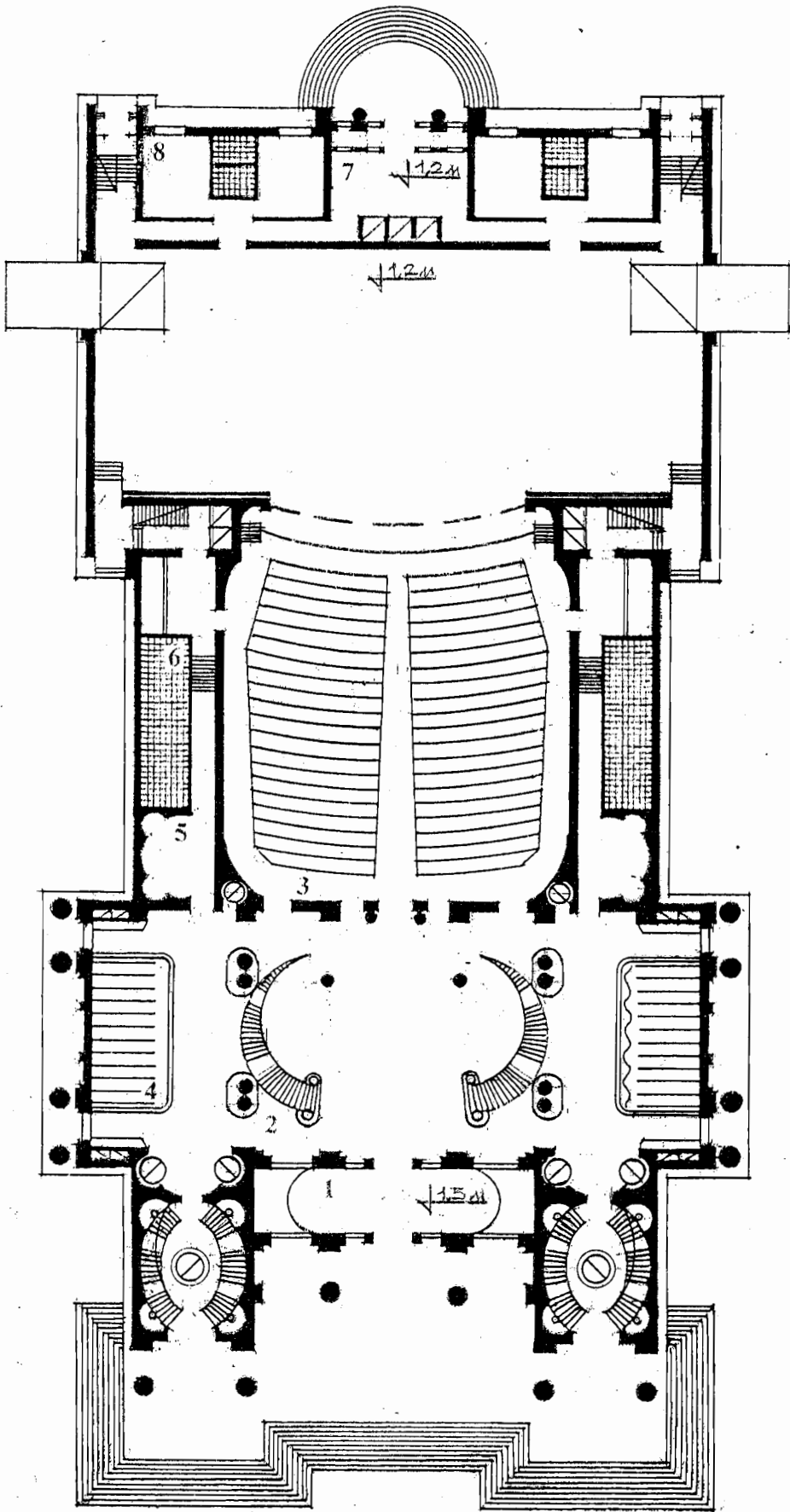

PLAN OF 1ST FLOOR

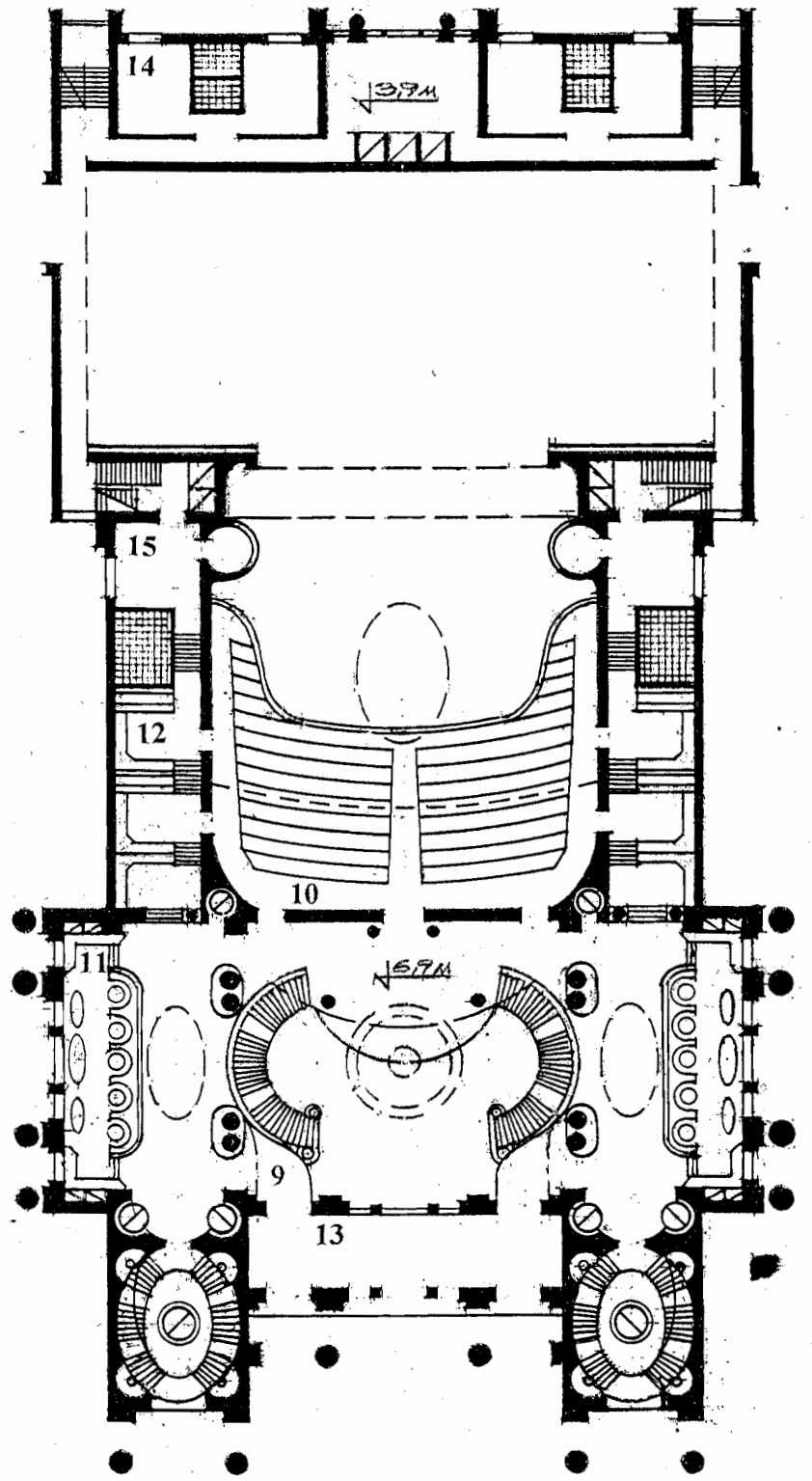

PLAN OF 2ND FLOOR

EXPLICATION

1 - tickets - entrance hall; 2 - vestibule - foyer; 3 - main hall - orchestra; 4 - cloak-rooms for coats; 5 - rooms for putting in order hair and clothes; 6 - restrooms; 7 - vestibule of the block of auxiliary premises; 8 - dressing rooms; 9 - foyer of 2nd floor; 10 - main hall - mezzanine; 11 - restaurants fenced off by glass partitions; 12 - non-alcoholic bars; 13 - winter - garden (in winter season) open balcony (in summer season); 14 - dressing rooms; 15 - boxes and foyers of management

EXPLANATION TO THE PROJECT

The theatre is intended for performing musicals and big plays. The main hall includes the orchestra, the mezzanine, and the balcony, and contains 1000 seats (width of row is 0.86m/35", width of armchair is 0.5m/1.6 ft). The building includes also the museum of the theatre, and two drama schools with rehearsal -- performing halls with 75 seats each.

On the ground floor there are disposed: under vestibule-foyer - museum; under rooms for putting in order hair and rest rooms - smoking saloons and restrooms; under cloak rooms for coats - kitchens for restaurants and cafeterias. In the block of auxiliary premises under dressing rooms -- mechanical workshops and premises for technical staff are located.

On the 3rd floor there are disposed: above foyer of 2nd floor - foyer of 3rd floor; above restaurants - cafeterias; above bars and restrooms of 2nd floor - bars and restrooms of 3rd floor. In the block of auxiliary premises - above dressing-rooms of 2nd floor there are four floors of dressing rooms and one floor of management's rooms. Above foyer and boxes of managements there foyer and boxes for the press, and then - premises and boxes of persons in charge of lighting effects are located.

On the level 17m/56' there are disposed: above side wings of foyer of 3rd floor - rehearsal-performing halls of drama schools, and above bars and restrooms of 3rd floor and premises of lighting effects staff - two floors of premises of drama schools are located: entrance halls (above premises of lighting effects staff), classrooms, dressing rooms, and management.

In the block of auxiliary premises (on level 20m/66') above floor of management's rooms there are two rehearsal halls of the theatre. Above the main hall - scenery and pictorial workshops are disposed.

The central part of the volume of foyers of 1st, 2nd, and 3rd floors is covered by vault. Height of whole open space under the vault from floor of vestibule-foyer to top of the vault is 24m/79'. The rehearsal- performing halls of the drama schools are opened in this space by semicircular windows like their windows on the side facades. In the zone of foyers 6 glass elevators for spectators and 2 elevators for staff are located. 2 glass elevators in the centers of oval staircases serve the drama schools, and are gathered by luminous threads.

**VIKTOR MASHINSKY
ARCHITECT**