

URBAN PLANNING SYSTEMS

SATELLITE TOWN FOR EUROPE

FOR DETAILED DESCRIPTION SEE PAGE 3

“A”- THE MODEL OF PRINCIPLE OF SATELLITE TOWN

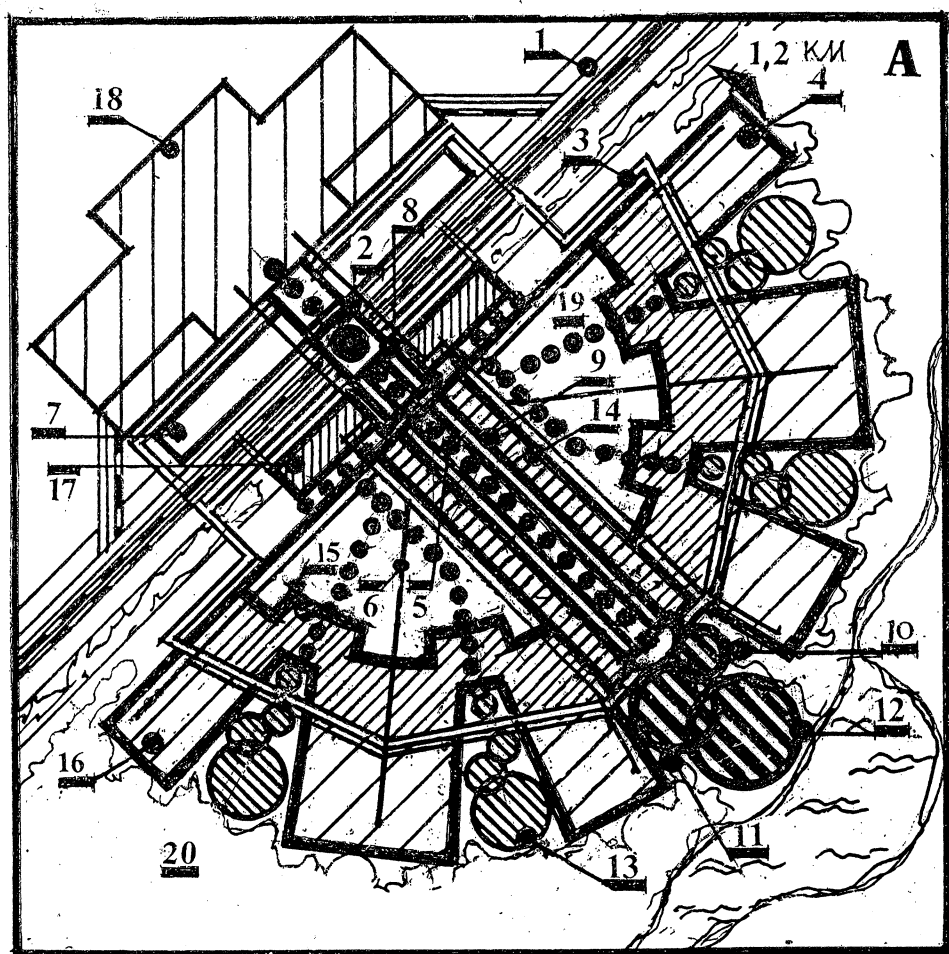

EXPLICATION

1- transport corridor of the system of settlement; 2- station of interurban transportation; 3- deepened beltway for ecologically clean and emergency transport; 4- dwelling zone of the town; 5- main pedestrian paths protected by awnings; 6- main bicycle paths; 7- multistory garage for private cars; 8- town administrative and social center; 9- town trade center; 10- town cultural center; 11- town education center; 12- town sports center; 13- public centers of peripheral dwelling districts; 14- area of 8-10-story apartment houses of the central dwelling district; 15- areas of 6-8- and 8-10-story apartment houses of peripheral dwelling districts; 15- areas of 1-2-story dwelling houses of peripheral dwelling districts; 17- business center; 18- town warehouse and industrial zones; 19- green areas of dwelling districts; 20- town green area.

“B”- THE MODEL OF PRINCIPLE OF TOWN TRADE CENTER AND CENTRAL DWELLING DISTRICT

I- town trade center; II- apartment houses of central dwelling district.

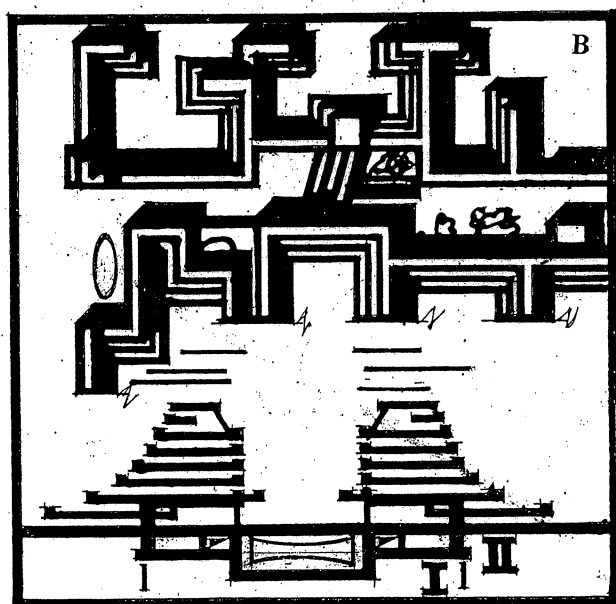

EXPLICATION

1- deepened beltway for ecologically clean and emergency transport. 2- pedestrian paths protected by awnings; 3- bicycle paths and approaches to houses; 4- agora of the public center of dwelling district; 5- social center; 6- trade center; 7- cultural center; 8- educational center; 9- sports center; 10- 6-8- story apartment houses; 11- 8-10-story apartment houses for young families and senior citizens; 12- 1-2 story dwelling houses with plots of land; 13- kinder gardens; 14- green area of the dwelling district with children play- and sports grounds.

* *

Produced plans “A”. “B” and “C” are very simplified in order to demonstrate planning ideas with maximum clarity. In actual designing both the town and its districts should be consistent with the local relief, landscape and microclimate.

“C”- THE MODEL OF PRINCIPLE OF PERIPHERAL DWELLING DISTRICT

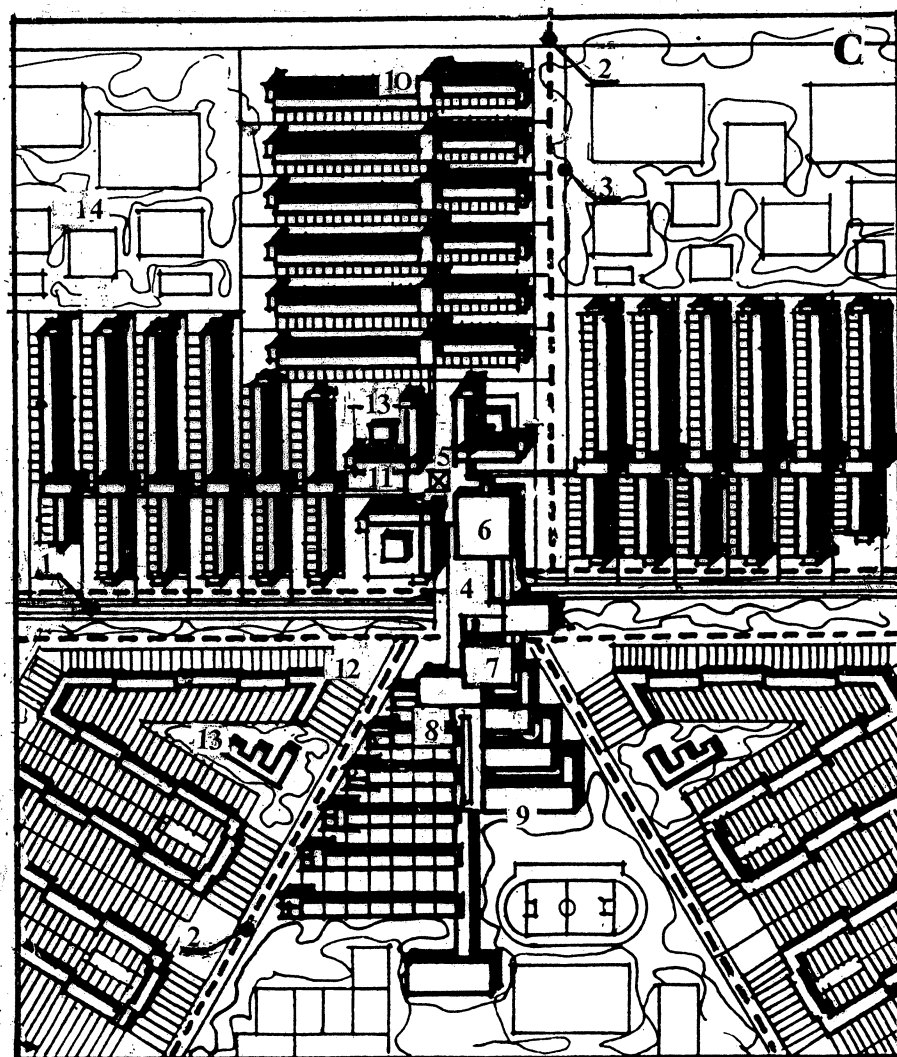

VIKTOR MASHINSKY
ARCHITECT